

LAMBOURDE

SUPPORT FOR GYPSUM BOARD



-  Gypsum Board
-  Lambourde
-  Interior wall
-  Slab

ADVANTAGES

1. Excellent thermo-acoustic system performance
2. Excellent mechanical strength
3. Excellent system inertia
4. Dimensional stability of the material
5. High durability without loss of features
6. Healthier natural product
7. Comfort with healthy insulation
8. Excellent breathability capacity
9. Allows energy savings
10. Long term effectiveness

100%
NATURAL
CHOICE

EXPANDED
INSULATION
CORKBOARD IS
A SUSTAINABLE
MATERIAL FOR
A SUSTAINABLE
INSULATION

LAMBOURDE

SUPPORT FOR GYPSUM BOARD

SOLUTION DESCRIPTION

Thermal and acoustic insulation using Lambourde System simultaneously acting as sound insulation and reducing heat flow. Ideal for rehabilitation/renovation.

TECHNICAL FEATURES

Density: 110 to 120 kg/m³

Thermal conductivity: $\lambda = 0,037$ a $0,040$ W/m°C

Compression resistance at 10%: ≥ 100 KPa

Excellent dimensional stability

Fire Resistance: Euroclasse E

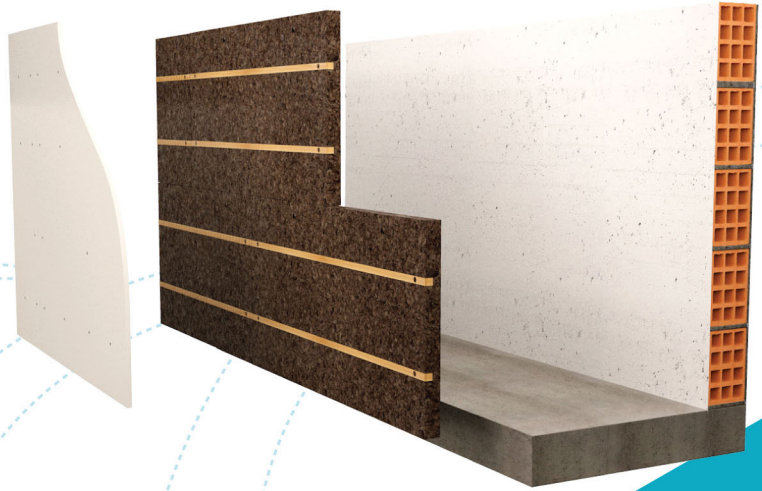

ENVIRONMENTAL FEATURES

- 100% NATURAL AND ADDITIVE-FREE INDUSTRIAL PROCESS
- DURABILITY OF 50 TO 60 YEARS WITHOUT LOSS OF CHARACTERISTICS
- TOTALLY RECYCLABLE
- SINK CO₂ (CARBON NEGATIVE)
- LOW EMBODIED ENERGY
- NO EMISSION OF HARMFUL COMPOUNDS FOR INDOOR AIR QUALITY

PRODUCT DIMENSIONS

Standard: 1000x500x [40 to 100mm] with two OSB strips embedded in corkboard

RECOMMENDATIONS FOR APPLICATION

Fix Lambourde board to wall for subsequent placement of gypsum board or other.